

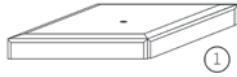

MIRRORED JEWELRY NECKLACE HOLDER

Parts Included



(A) Mirror Base - 1pc



(B) Main Pole - 1pc

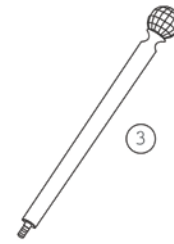

(C) Arms - 2pcs

Hardware Included:

- (D) Bolt 1pc
- (E) Metal Washer 1pc
- (F) Plastic Washer 1pc

Tool that you may need:

- Phillips Screwdriver

Assembly Instructions:

Step 1: Place the base (A) on a flat surface upside down. Put the metal washer (E) onto the bolt (D) and then insert the bolt through the hole of the base, as shown below.

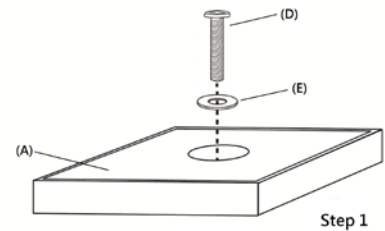

Step 2: Place the base (A) on its side on a flat surface (hold the inserted bolt of Step (1)). Put the plastic washer (F) onto the protruding portion of the bolt of Step (1) and then thread the threaded end of the main pole (B) onto the bolt. Use your hands to spin the main pole onto the bolt until tight (use a screwdriver to hold the screw in place during this tightening, if necessary).

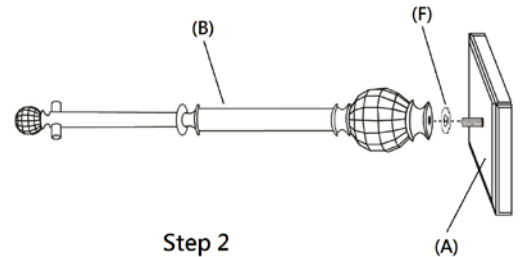

Step 3: Upright the assembly on its base and then thread an arm (C) into each threaded opening located at the top of the main pole (B). Rotate the arms clockwise by hand until tight.

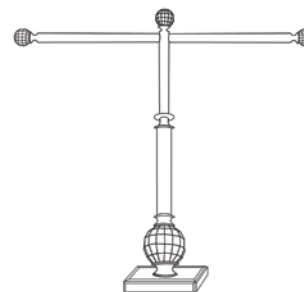
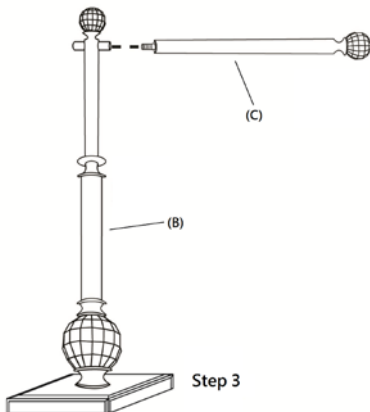

Completed Assembly

Care Instructions:

Do not use abrasives or household cleaners as they may damage the finish on the product.

Thank you for your purchase!
www.pbteen.com