



The hardware included with this item is meant for dry wall mounting only. If walls are concrete, brick or plaster, please consult your local hardware store for assistance.

Study Board: Triple

Parts Included: TWO Mounting Screws, TWO Mounting Anchors, ONE Template, FIVE Ledge Screws, TEN Pushpins. ONE Dry eraser pen and ONE Wood eraser.

Tools Required: Phillips Head Screwdriver, Level, Pencil, Tape, Stud Finder

Assembly Instructions: Referring to the below image, this item includes a ledge which is meant to be attached along a bottom edge of the board using three provided screws. Align the pre-drilled holes of the ledge with the holes located at the bottom edge of the board. Make sure that the ledge is correctly positioned upright and then use an (Allen Wrench or Screwdriver) to tighten the three screws.

Mounting Instructions:

1. Hold the provided mounting template at a desired location on a wall (use a level to ensure the template is level) and then use sticky tape to tape the template to the wall.
2. Using a pencil, mark the wall through the template at the location of the black dots located near the top of each Keyhole. Remove the template. The remaining marks on the wall are the insertion points for your mounting hardware.

Note: If either mark aligns with a wall stud (use a stud finder to determine this), do not use the provided anchors at that mark - they cannot penetrate wood. Either use a provided metal screw at that particular mark or simply move the two marks to the right or the left about 2 inches to avoid the stud. If you decide to use the stud mark, use the screwdriver to secure a screw directly into the wall and stud at that mark. Rotate the screw until the screw head is about 3/8 inch from the wall.

3. For the marks that do not align with a wall stud, use a screwdriver to install an anchor into the wall. Place the tip of the anchor at the mark and use the screwdriver to both rotate the anchor (clockwise) and firmly push it into the wall. The anchor will drive itself into the wall like a screw. Continue rotating the anchor until its wide flange is flush with the wall surface. Do not over-tighten. Repeat with the other anchor and other mark.
4. Use the screwdriver to secure a provided metal screw into each installed anchor. Rotate the screw clockwise until the screw head is about 3/8 inch from the wall.
5. With the help of another person, lift the item against the wall and engage the screw heads with the Keyholes. Gently lower the item so it rests on the screws.

Care Instructions: Wipe with a soft, dry cloth. Do not use of any strong abrasive or solvent-based household cleaner.

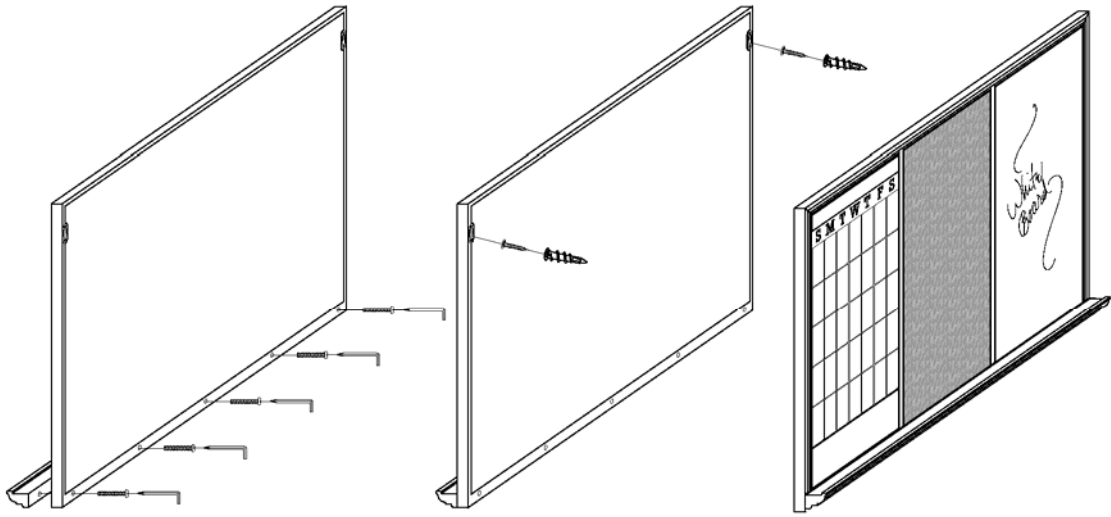

Figure # 1 → [Screw] → [Screw] → [Screw]
Figure # 2 → [Screw] → [Screw] → 0

www.pbteen.com