

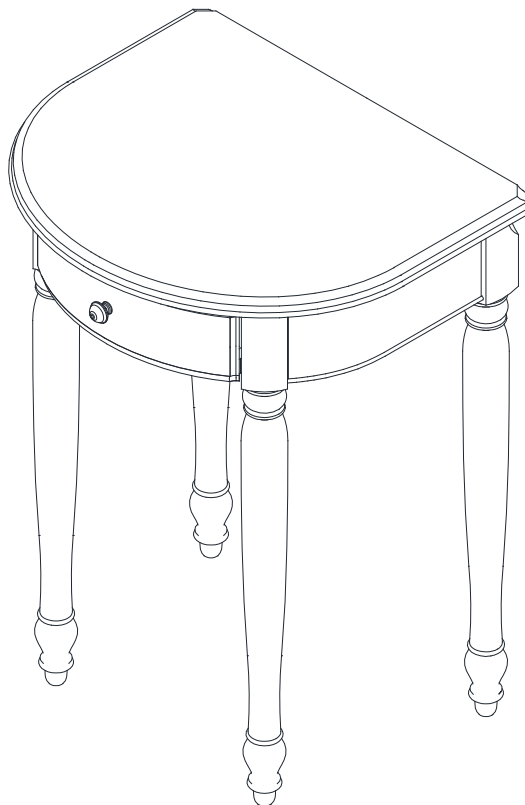

## SOPHIE NIGHTSTAND

### ASSEMBLY INSTRUCTIONS



### Important Safety Instructions:

- Please read all instructions carefully before assembling this nightstand.
- For your safety, assembly by two or more adults is strongly recommended.
- Keep these instructions for future use.
- Use only vendor-supplied hardware to assemble this item. Using unauthorized hardware could jeopardize the structural integrity of the item.

### Pre-assembly:

- Remove all parts and hardware from the box. Place them on a carpeted or scratch-free work surface, as this will avoid damaging parts during assembly. The shipping box provides an ideal work surface.
- To avoid accidentally discarding small parts or hardware, do not dispose of any packaging or contents of the shipping carton until assembly is complete.
- Use the parts and hardware lists below to identify and separate each of the pieces included.
- The illustrations provided allow for easier assembly when used in conjunction with the assembly instructions.
- The use of power tools to aid in assembly is not recommended. Power tools can damage the hardware and split the wood.

### Parts Included:

(A) Top - 1x

(B) Leg - 4x

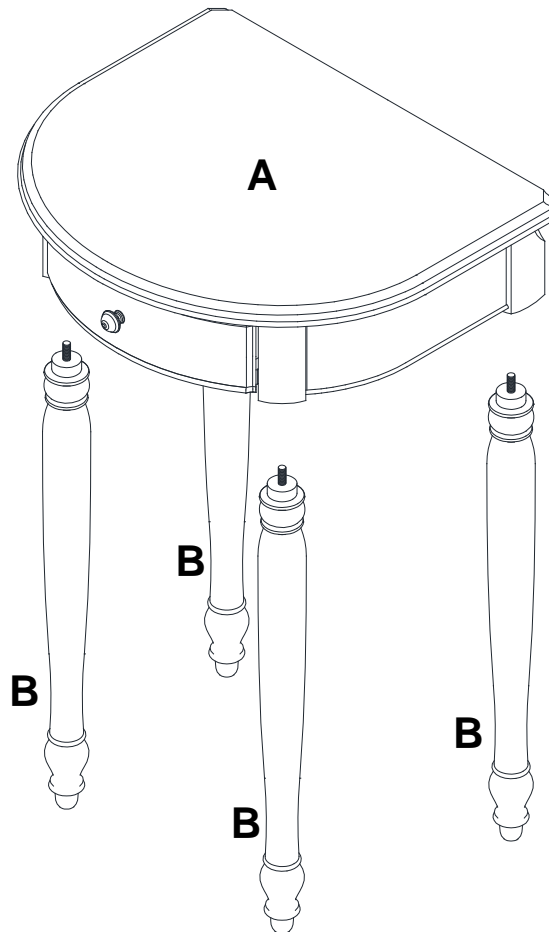

### Assembly Instruction Steps:

1. Place Top (A) upside down on a soft, scratch free surface such a carpet or rug.
2. Thread the 4 Legs (B) into the bottom of Top (A) in a clock-wise direction until tight, as seen in the illustration below.

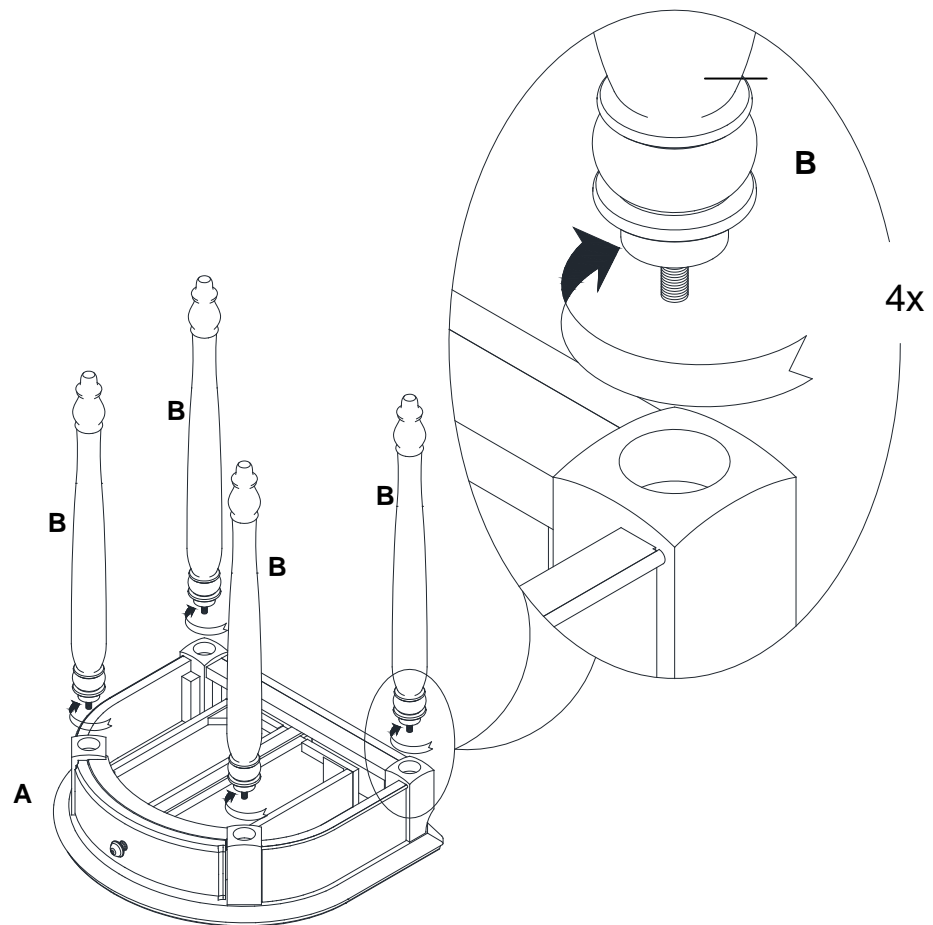

3. Slowly turn the Nightstand upright.
4. If needed, adjust the levelers located on the bottom of the legs to keep the Nightstand level.

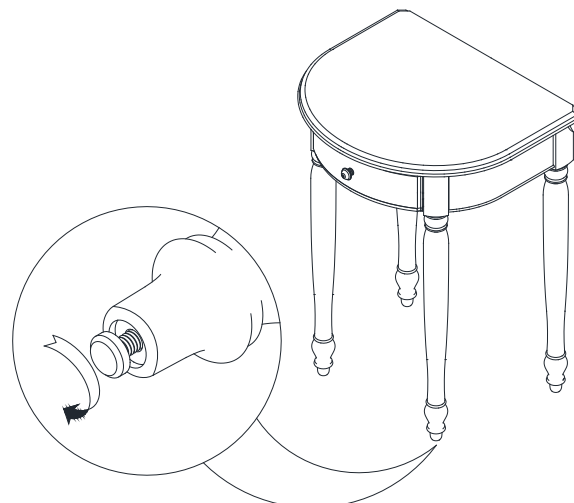

### Care Instructions:

- Dust often using a clean, soft, dry, and lint-free cloth.
- Blot spills immediately and wipe with a clean, damp cloth.
- We do not recommend the use of chemical cleansers, abrasives, or furniture polish on our lacquered finish.
- Hardware may loosen over time. Periodically check to make sure all connections are tight.  
Re-tighten if necessary.