

## LOCKER WALL SYSTEM

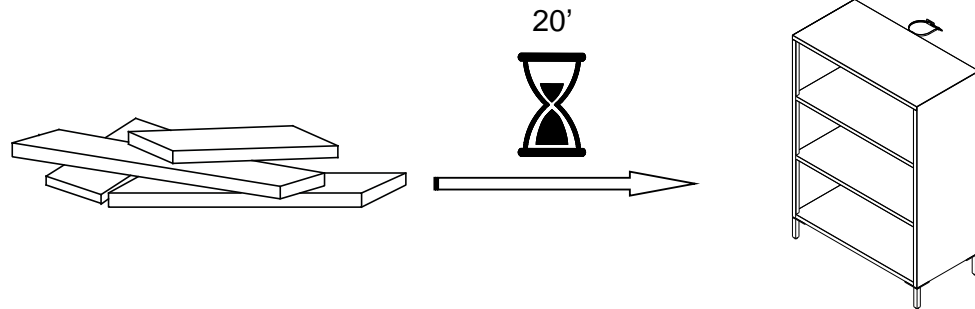

## ⚠ ENGLISH

- Do not dispose of any packaging or contents of the shipping carton until assembly is completed to avoid accidentally discarding small parts or hardware.

## ⚠ FRANÇAIS

- Ne jetez rien des produits d'emballage et du contenu de la boîte jusqu'à ce que l'assemblage soit terminé, afin d'éviter de jeter par mégarde de petites pièces ou des morceaux.

## ⚠ ESPAÑOL

- Para evitar desechar accidentalmente las partes pequeñas o las piezas de ferretería, no tirar el embalaje o contenido de la caja hasta que el ensamblaje esté completo.

### Care Instructions:

- Dust often using a clean, soft, dry and lint-free cloth.
- Blot spills and wipe with a clean, damp cloth immediately.
- We do not recommend the use of chemical cleansers, abrasives or furniture polish on our lacquered finish.
- Hardware may loosen over time. Periodically check to make sure all connections are tight. Re-tighten if necessary.

### Instructions d'entretien :

- Épousseter régulièrement avec un chiffon propre, doux et non pelucheux.
- Éponger immédiatement les liquides renversés et essuyer à l'aide d'un chiffon propre et humide.
- L'utilisation de produits nettoyants chimiques, d'abrasifs ou d'encaustiques sur nos finitions laquées n'est pas recommandée.
- Le matériel de fixation peut se desserrer avec le temps. Vérifiez régulièrement afin de vous assurer que tous les raccords sont bien serrés. Resserrez-les au besoin.

### Instrucciones de cuidado:

- Limpiar el polvo con un trapo limpio, suave, seco y libre de pelusas.
- Secar los derrames de inmediato y limpiar con un trapo limpio y húmedo.
- Recomendamos no usar limpiadores químicos, abrasivos o lustramuebles sobre el acabado barnizado.
- Las piezas de ferretería pueden aflojarse con el tiempo. Controlar periódicamente que estén bien ajustadas. Si es necesario, volver a ajustarlas.

# Williams-Sonoma Inc.

Assembly Instructions  
Instructions d'assemblage  
Instrucciones de Ensamblaje

Pottery Barn – Pottery Barn Teen – Pottery Barn Kids – Williams Sonoma Home – West Elm – Rejuvenation – Mark and Graham – GreenRow

23-December-2023

3/11

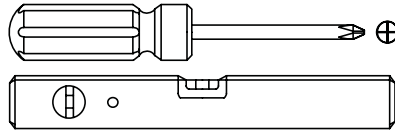
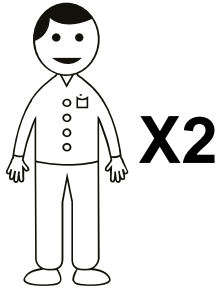

NOT INCLUDED / NON INCLUS / NO INCLUIDAS

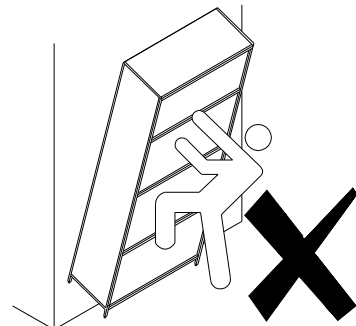
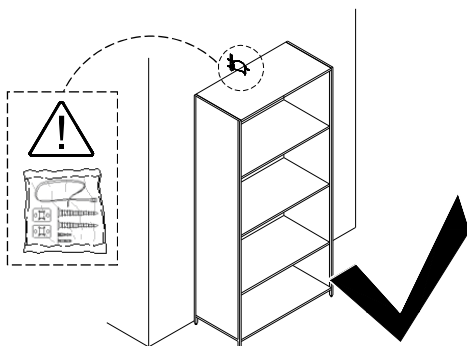
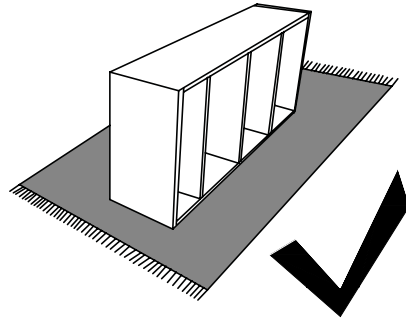
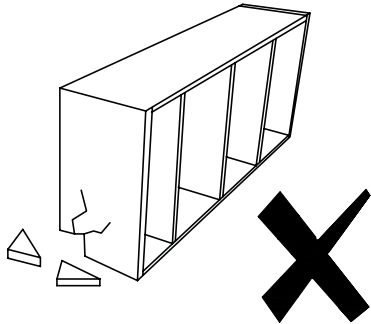
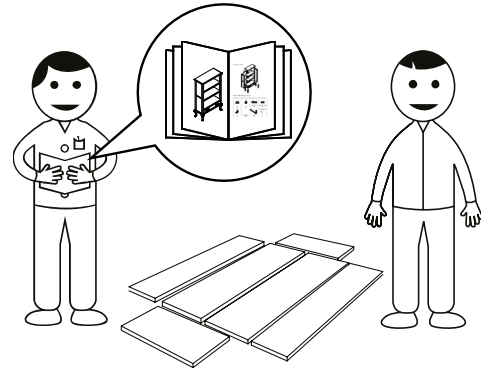
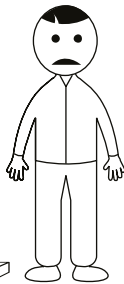
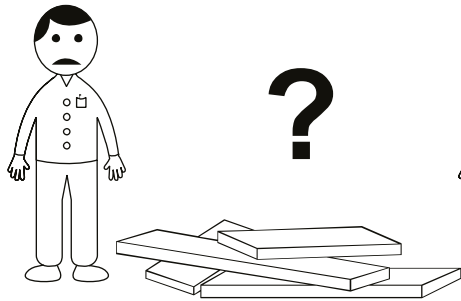
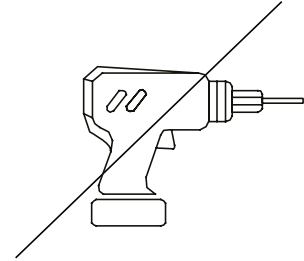

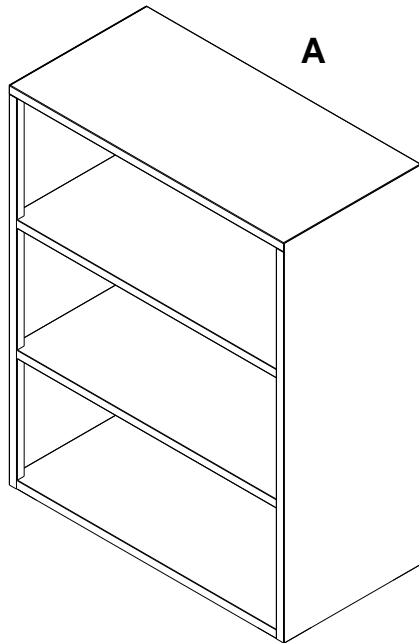

**Locker Wall System Base**  
**Base du système mural de casier**  
**Base del sistema de pared con armario**

( Sold separately )  
 ( Vendu séparément )  
 ( Se vende por separado )

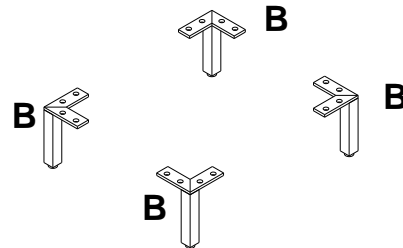

**HARDWARE INCLUDED / ( MATÉRIEL INCLUS ) / ( PIEZAS DE FERRETERÍA INCLUIDAS )**

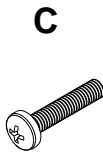

**C**  
**JP M4x10mm**  
**2x**



**D**  
**2x**

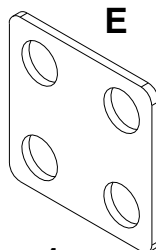

**E**  
**1x**

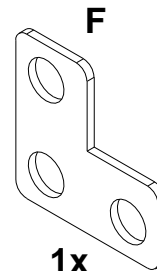

**F**  
**1x**



**G**  
**Anti-tip kit**  
**Dispositif anti-basculement**  
**Kit anti-volcada**

**1x**

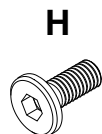

**H**  
**M6x20**  
**16x**

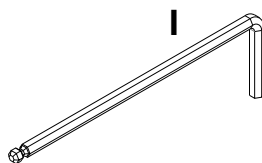

**I**  
**#4**  
**1x**

**HARDWARE INCLUDED from Locker Wall System Base**  
**MATÉRIEL INCLUS à partir de la base du système mural de casier**  
**PIEZAS DE FERRETERÍA INCLUIDAS de la base del sistema de pared con armario**

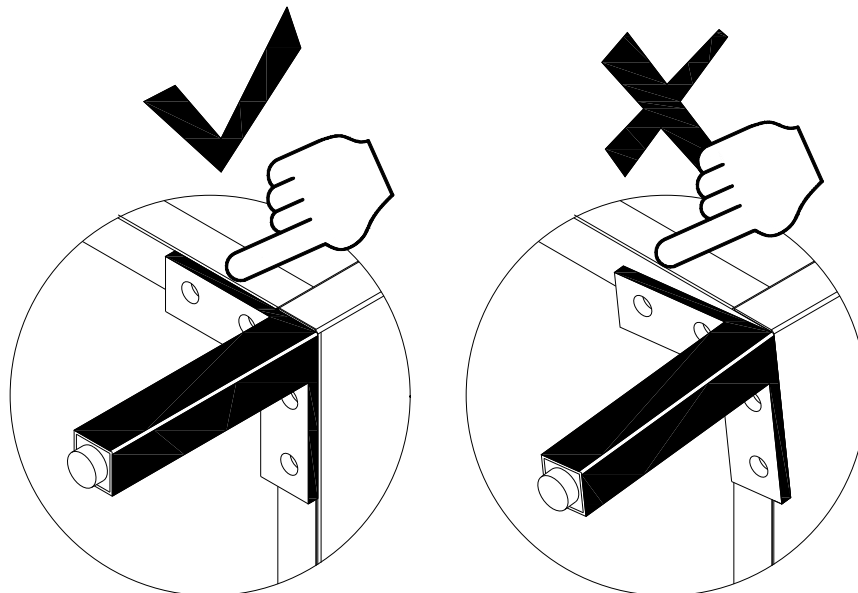
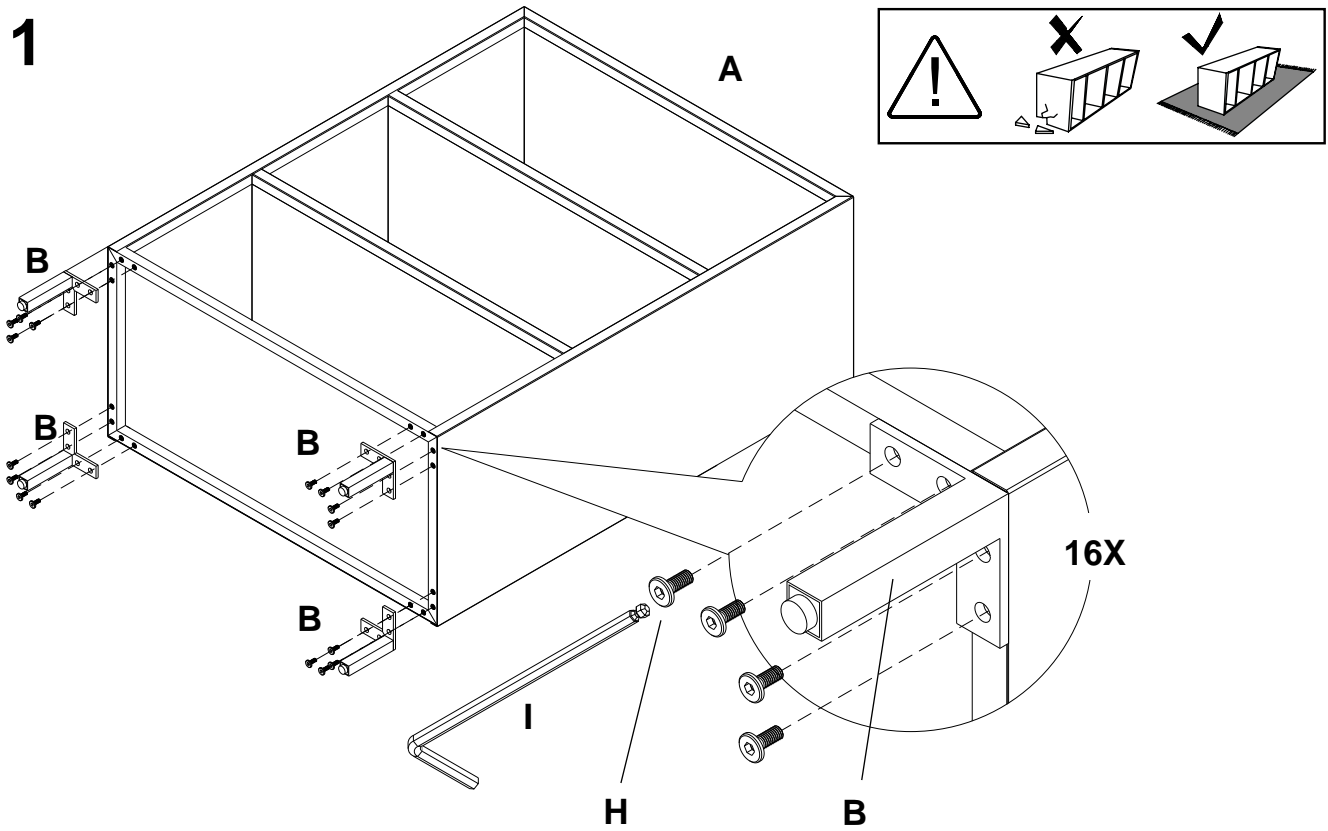

## 2

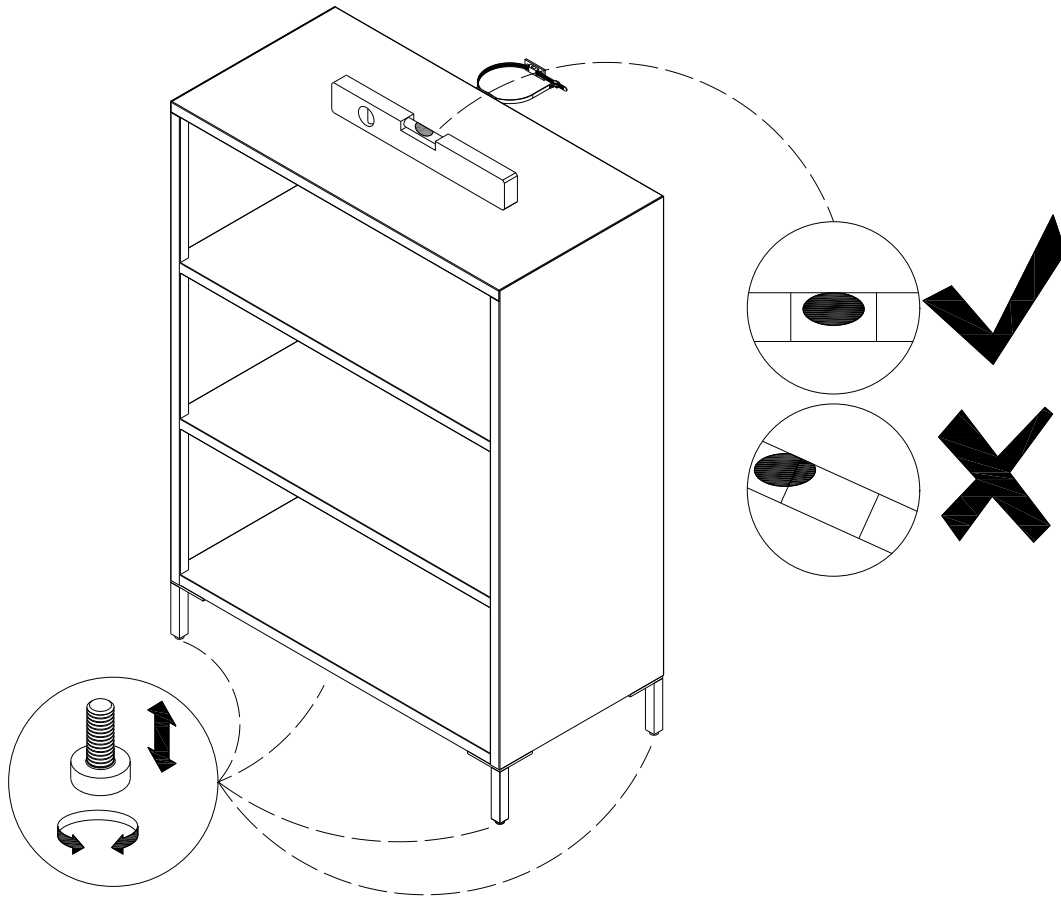

## 3

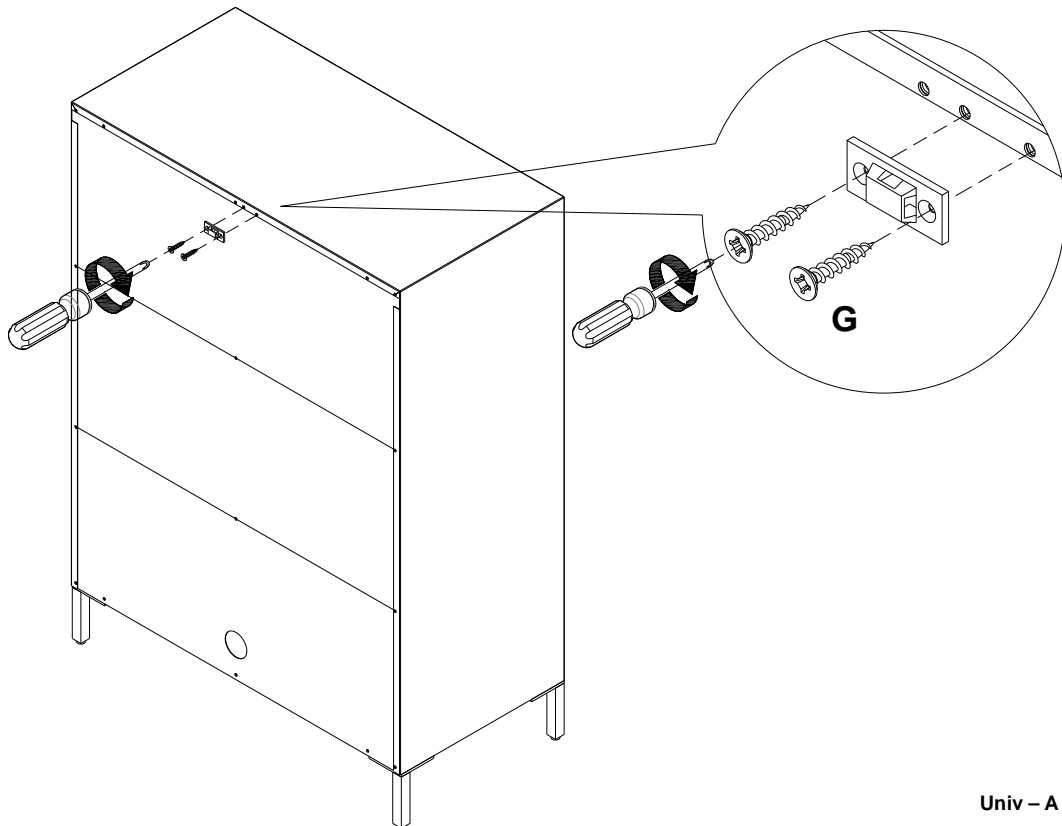

## 4

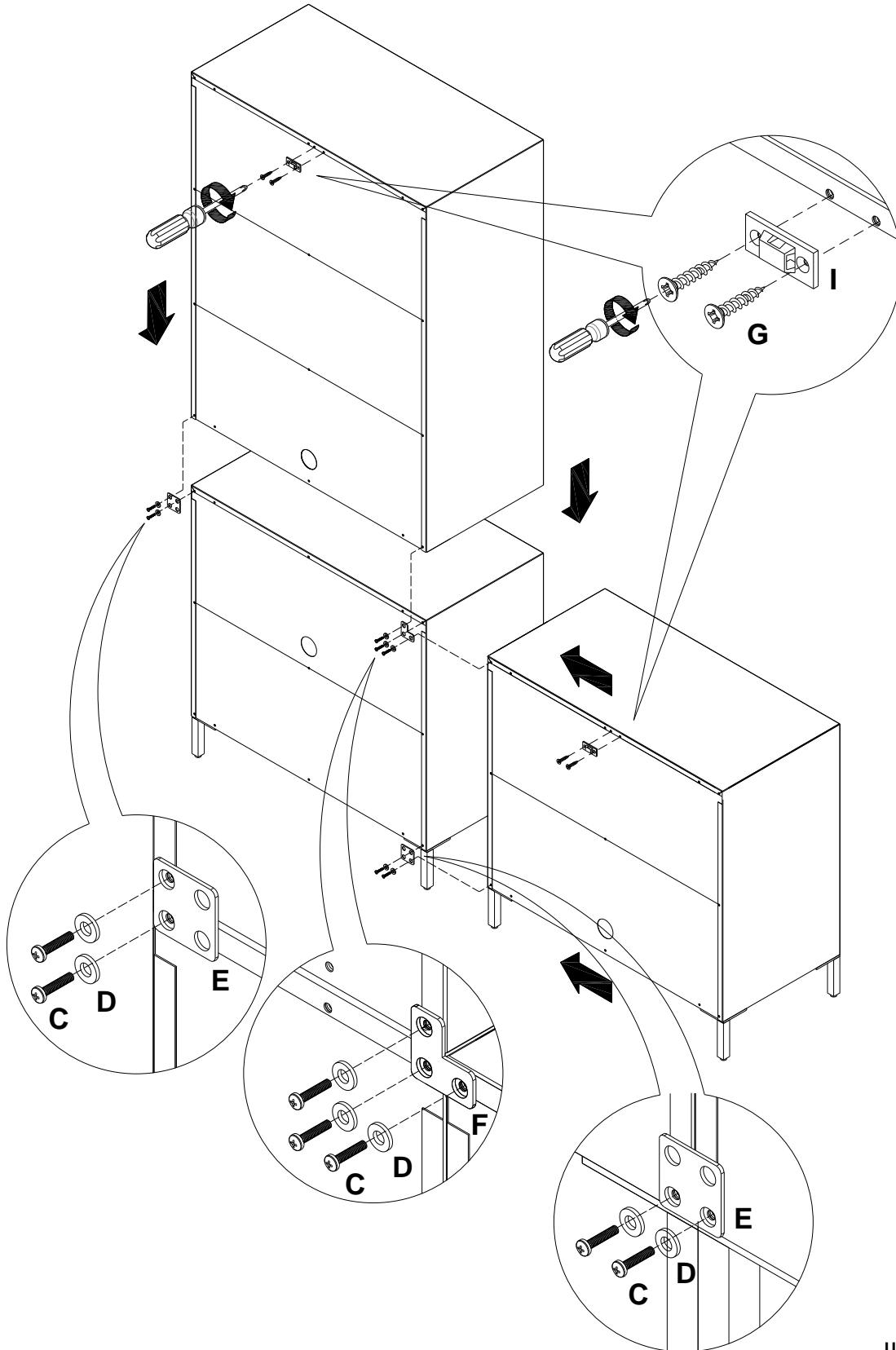

## 5

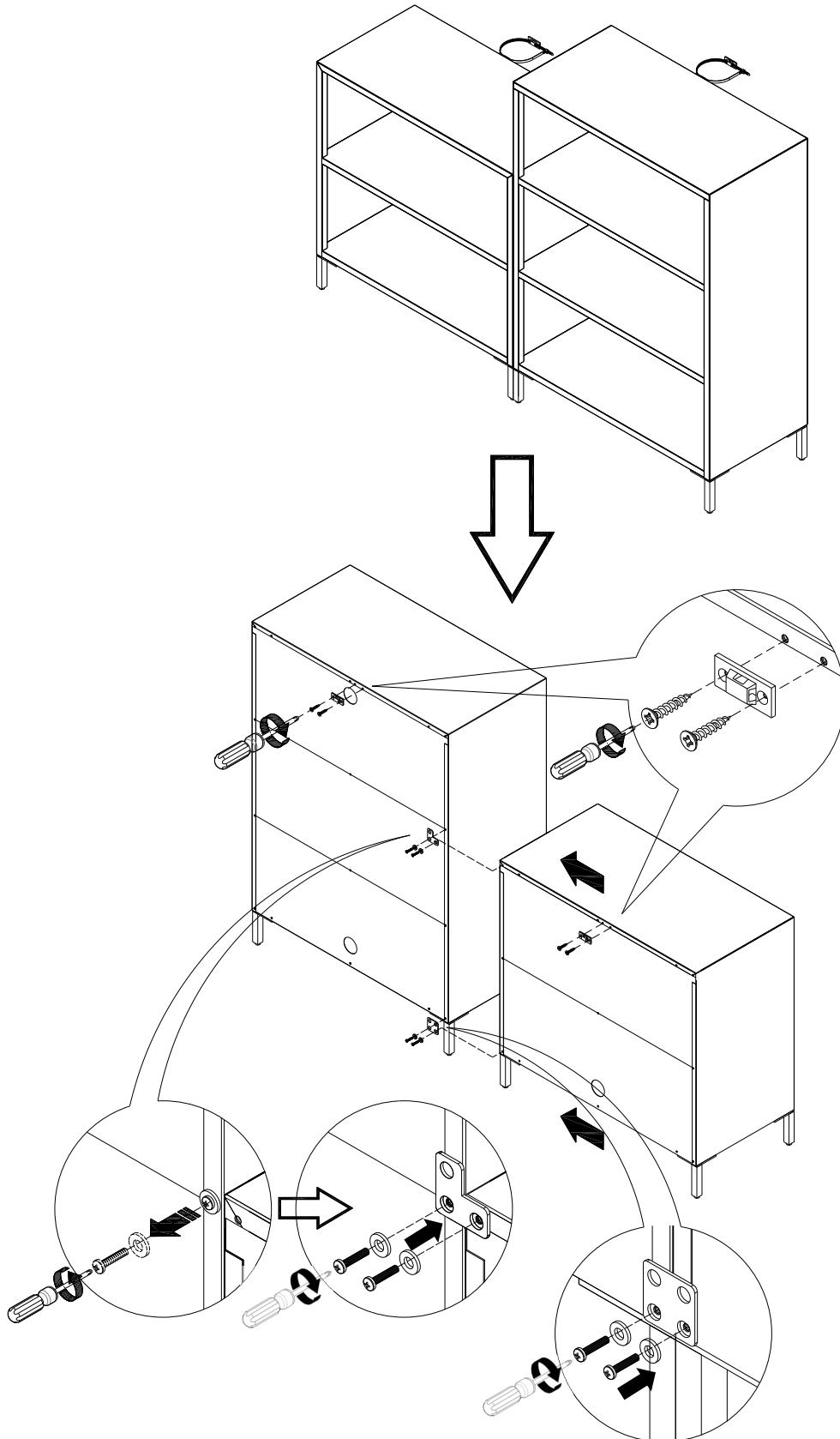



**6** Note : Always put the one drawer on the bottom, do not recommend to put the one drawer to the top of the case.

Remarque : Toujours placer le tiroir unique au bas, il n'est pas recommandé de le placer en haut du cadre  
Nota: Siempre colocar el cajón en la parte inferior. No es recomendable colocar el cajón en la parte superior

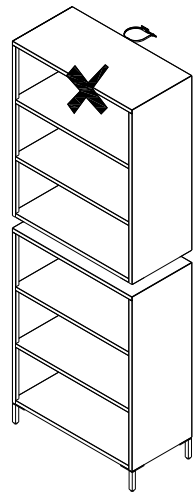
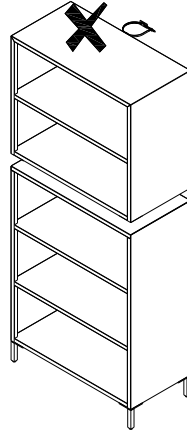
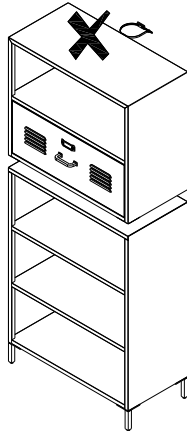
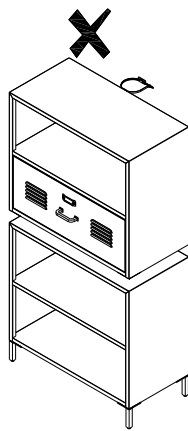
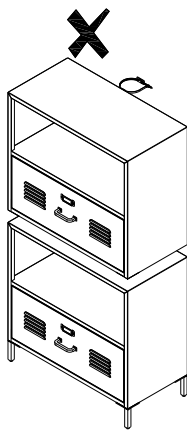
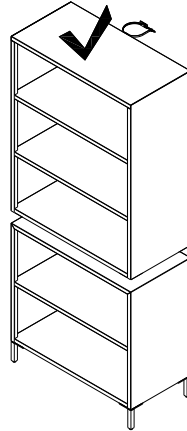
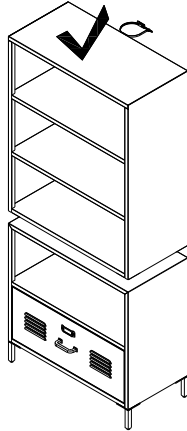
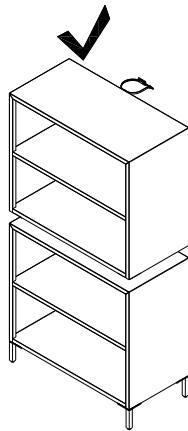
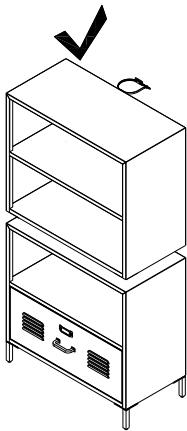

## 7 Configuration Locker Wall System ( Sold separately ) Configuration du système mural de casier (vendu séparément) Configuración del sistema de armario para pared (se vende por separado)

**Note :** Always put the one drawer on the bottom, do not recommend to put the one drawer to the top of the case.

**Remarque :** Toujours placer le tiroir unique au bas, il n'est pas recommandé de le placer en haut du cadre

**Nota:** Siempre colocar el cajón en la parte inferior. No es recomendable colocar el cajón en la parte superior de la caja.

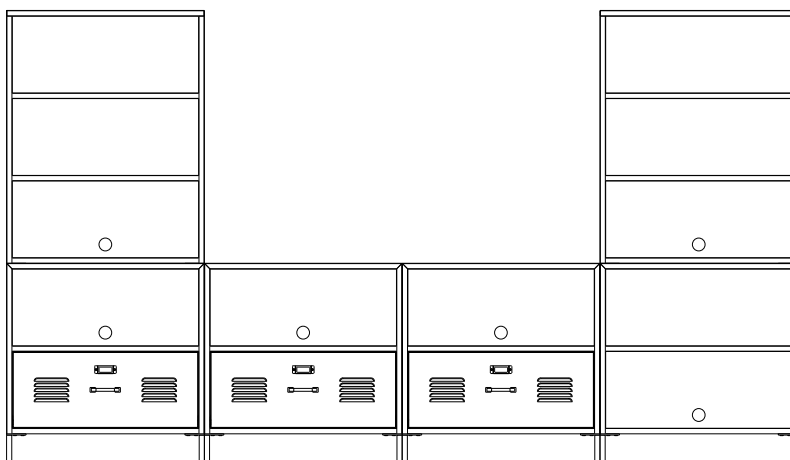
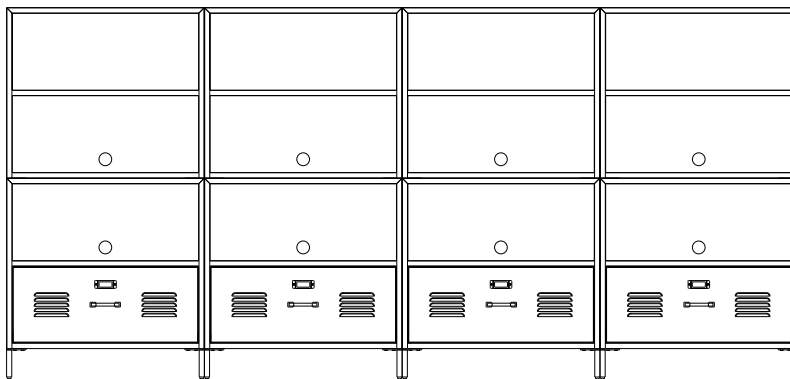
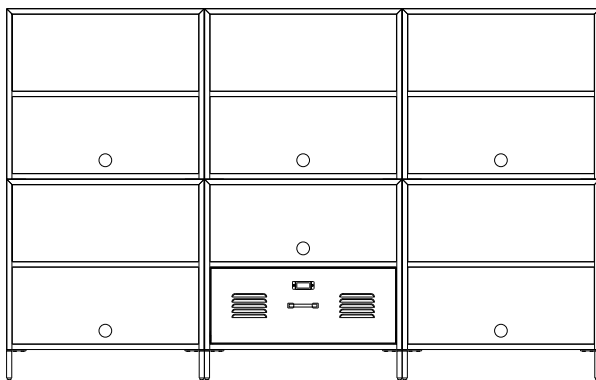

## 8

